

The DP Deep Well is a reliable convertible cast iron jet pump, designed for pressure boosting from tanks, rivers and dams. Ideal for irrigation or wash down applications with large suction depths the deep well pump has a suction capability of 8 to 27 m.

The Shallow Well DP151 and 251 models can be converted to a Deep Well pump with the addition of the Deep Well Ejector, selected from the tables on the following page. A complete Deep Well Pump system will require the addition of four riser pipes and an additional poly pipe and fittings.

The DP is available in 3 models: **M** = Single phase **T** = Three phase
M-P = Pressure switch and gauge included

DEEP WELL JET PUMP OPTIONS:

Deep Well Jet Pump (M/T)

- Available in single phase with 3m lead and plug (M) and three phase (T) versions

Deep Well Jet Pressure System (M-P)

- Complete as an single phase automatic version with pressure switch, pressure gauge fitted to the pump body and three way brass fitting for connection to a pressure tank
- The pressure tank must be selected and ordered separately to complete the pressure system

OPERATING CONDITIONS:

System pressure

Max 8 bar (800kPa)

Liquid temperature

0°C to +40°C for other uses
0°C to +35°C for domestic use

Maximum ambient temperature

+40°C

Maximum suction depth

27 metres by means of an ejector to be inserted in wells

CONSTRUCTION:

Materials

- Cast iron pump body and motor support
- Technopolymer impeller and diffusers
- Stainless steel adjustment rings
- Carbon/ceramic mechanical seal
- Cast bronze impeller

Protection level

IP44 (IP55 terminal board protection)
IP56 pressure switch gauge

Insulation class

F



DEEP WELL EJECTOR KITS:

The DP - convertible jet pump requires a deep well ejector kit to complete the system.

EJECTOR KIT ASSEMBLY:



All threaded joints should be sealed appropriately either by Teflon tape or an approved sealant. Note: The entire system must be air and water tight for efficient operation.

The DAB Deep Well Ejector Kit does not include any short riser pipes and poly connectors.

To complete the Deep Well System the user will require pump short riser pipes, 90 degree poly connectors, ejector short riser pipes and ejector poly connectors and poly pipe.

Do not use piping of sizes smaller than those listed in table (next page) or the pump will not operate correctly.

INSTRUCTION FOR CONVERSION:

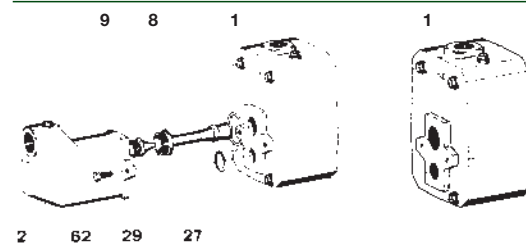

Conversion from DP 151-251 to JET 151-251

- Screw the nozzle (9) into place on the ejector's body (2) and the Venturi tube (8).
- Put the O-rings (27) and (29) in their respective places and fix the ejector body (2) to the pump body (1) using the two screws (62).

Conversion from JET 151-251 to DP 151-251

- Loosen and remove the two screws (62) connecting the ejector body (2) to the pump body (1).
- Save the O-rings (27) and (29), the Venturi tube (8) and the nozzle (9).

PERFORMANCE CHART:

M - T = Single-phase (M) and Three-phase (T)

HYDRAULIC DATA (n ~ 2800 1/min.)														
MODEL	EJECTOR TYPE	SUCTION DEPTH	Delivery pressure in bar											
			1.5	2	2.5	3	3.5	4	4.5	5	5.5	6	6.5	7
Capacity table in l/h														
DP 151 M - T	E 20	9	-	-	-	3470	2890	2220	1500	750	-	-	-	-
		12	-	-	-	3110	2510	1850	1100	300	-	-	-	-
		15	-	-	-	2710	2100	1380	640	-	-	-	-	-
		18	-	-	-	2360	1700	950	-	-	-	-	-	-
	E 25	15	-	-	-	2800	2330	1830	1350	900	520	-	-	-
		18	-	-	-	2530	2050	1550	1090	680	300	-	-	-
		21	-	-	-	2280	1800	1300	860	470	-	-	-	-
	E 30	21	-	-	-	1820	1650	1410	1160	910	700	520	-	-
		24	-	-	-	1680	1520	1260	1020	780	580	420	-	-
27		-	-	-	1550	1360	1110	880	680	490	330	-	-	
DP 251 M - T	E 20	9	-	-	-	4300	3600	2900	2180	1400	640	-	-	-
		12	-	-	-	3750	3140	2540	1700	940	-	-	-	-
		15	-	-	-	-	2780	2040	1300	500	-	-	-	-
		18	-	-	-	-	2340	1610	820	-	-	-	-	-
	E 25	15	-	-	-	-	2920	2400	1900	1400	950	570	-	-
		18	-	-	-	-	2600	2110	1620	1150	720	360	-	-
		21	-	-	-	-	2350	1850	1350	900	510	-	-	-
		24	-	-	-	-	2050	1550	1080	660	300	-	-	-
	E 30	21	-	-	-	-	-	1710	1480	1220	980	770	590	420
		24	-	-	-	-	-	1580	1330	1080	850	670	490	330
		27	-	-	-	-	-	1440	1200	950	750	560	400	250

DIMENSIONS:

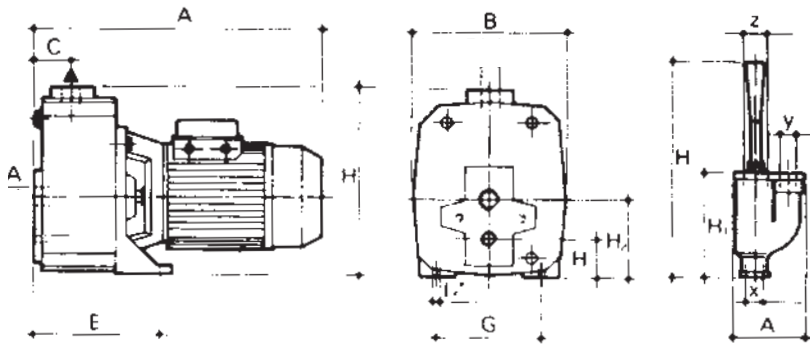

PIPE SIZES REQUIRED BETWEEN WATER SOURCE AND PUMP:

Distance to Water pump	DP151		DP251	
	Suction	Pressure	Suction	Pressure
0 - 30m	32mm	25mm	32mm	25mm
30 - 100m	40mm	32mm	40mm	32mm
100 - 200m	50mm	40mm	50mm	40mm
Over 200m	50mm	50mm	50mm	50mm

MODEL	CODE	PRICE (Incl GST)
EJECTORS E 20	109200000	\$91.00
EJECTORS E 25	109200020	\$91.00
EJECTORS E 30	109200010	\$91.00

TECHNICAL DATA:

- List price does not include the deep well ejector or required pipe and fittings. Pressure systems require the addition of a pressure tank

Pump Model	P2 (kW)	1 ph In (A)	Water Temp (°C)	Voltage (V)	Automatic	Connections		Weight (kg)	Dimensions (mm)								LIST Price (incl. GST)
						Inlet	Outlet		A	B	C	E	G	H	H1	H2	
DP 151 M	1.10	7.00	0/40	1 x 230	X	1 ¼" F	2 x 1" F	28.5	388	210	50	197	145	155	52	108	\$914.00
DP 251 M	1.85	8.30	0/40	1 x 230	X	1 ¼" F	2 x 1" F	32.5	462	210	50	197	145	155	53	108	\$1,006.00
DP 151 T	1.45	4.72	0/40	3 x 415	X	1 ¼" F	2 x 1" F	28.5	388	210	50	197	145	155	52	108	\$914.00
DP 251 T	1.85	5.63	0/40	3 x 415	X	1 ¼" F	2 x 1" F	27.9	462	210	50	197	145	155	53	108	\$1,006.00
DP 151 M-P	1.10	7.00	0/40	1 x 230	✓	1 ¼" F	2 x 1" F	28.0	388	210	50	197	145	155	52	108	\$1,098.00
DP 251 M-P	1.85	8.30	0/40	1 x 230	✓	1 ¼" F	2 x 1" F	32.5	462	210	50	197	145	155	53	108	\$1,144.00